

Serenity Creek | Foxtail

2,316 sq. ft. | 4 Bed | 2 Bath | 3 Car Garage | 1 Story

FLEX LIVING OPTIONS: Opt. Second Floor Game Room, Bedroom 5, Bath 4 & Opt. Wet Bar, Opt. Study or Game Room ILO Bedroom 4, Opt. Study ILO Flex, Opt. Master Bath, Opt. Bath 3 or Powder Bath ILO Second Master W.I.C., Opt. Tray Ceiling in Master Suite and Foyer, Opt. Covered Lanai 1, 2, or 3

Any floorplan and/or elevation rendering is an artist's conceptual rendering intended to provide a general overview, but any such rendering does not constitute actual plans and specifications for any home. Renderings and pictures are representative and may depict floorplans, elevations, options, upgrades, landscaping, and other features and amenities that are not included as part of all homes and/or may not be available for all lots and/or in all communities. Renderings may not be drawn to scale. Any provided dimensions are approximate and actual dimensions may vary. Homes may be constructed with a floorplan that is the reverse of the floorplan rendering. Plans are copyrighted and/or otherwise subject to intellectual property rights of Meritage and/or others and cannot be reproduced or copied without Meritage's prior written consent. Plans and specifications, home features, and community information are subject to change, and homes to prior sale, at any time without notice or obligation. Additionally, deviations and variations may exist in any constructed home, including, without limitation: (i) substitution of materials and equipment of substantially equal or better quality; (ii) minor style, lot orientation, and color changes; (iii) minor variances in square footage and in room and space dimensions, and in window, door, utility outlet, and other improvement locations; (iv) changes as may be required by any state, federal, county, or local governmental authority in order to accommodate requested selections and/or options; and (v) value engineering and field changes.

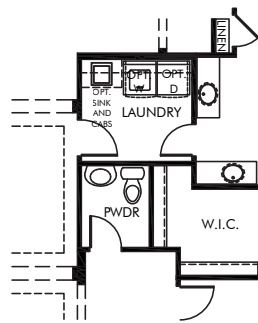

OPT. POWDER BATH ILO W.I.C.
(NOT AVAILABLE IF UPPER FLOOR IS SELECTED)

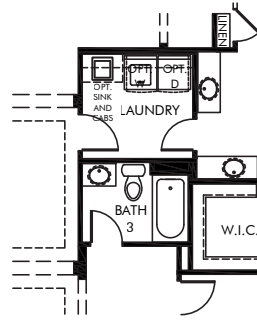

OPT. BATH 3 ILO W.I.C.

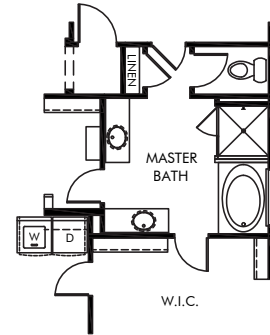

OPT. MASTER BATH 1

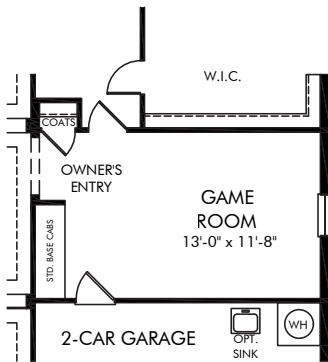

OPT. GAME ROOM ILO
BEDROOM 4

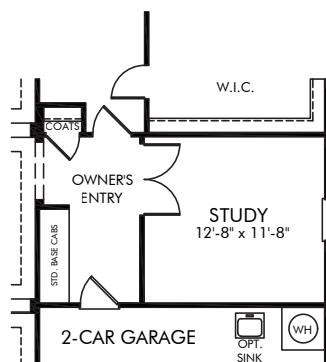

OPT STUDY ILO
BEDROOM 4

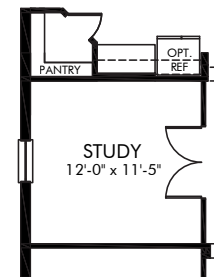

OPT. STUDY ILO FLEX

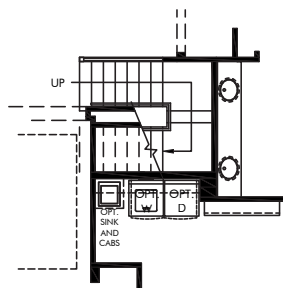

OPT. UPPER FLOOR STAIRCASE

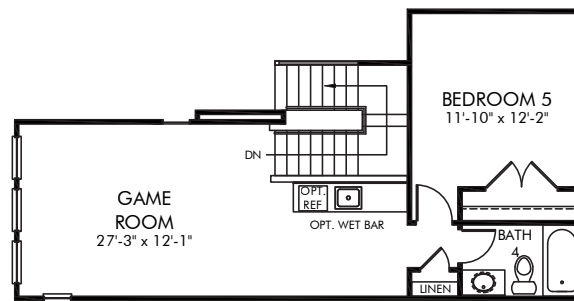

OPT. SECOND FLOOR PLAN

Serenity Creek | Foxtail | Options

2,316 sq. ft. | 4 Bed | 2 Bath | 3 Car Garage | 1 Story

FLEX LIVING OPTIONS: Opt. Second Floor Game Room, Bedroom 5, Bath 4 & Opt. Wet Bar, Opt. Study or Game Room ILO Bedroom 4, Opt. Study ILO Flex, Opt. Master Bath, Opt. Bath 3 or Powder Bath ILO Second Master W.I.C., Opt. Tray Ceiling in Master Suite and Foyer, Opt. Covered Lanai 1, 2, or 3

Any floorplan and/or elevation rendering is an artist's conceptual rendering intended to provide a general overview, but any such rendering does not constitute actual plans and specifications for any home. Renderings and pictures are representative and may depict floorplans, elevations, options, upgrades, landscaping, and other features and amenities that are not included as part of all homes and/or may not be available for all lots and/or in all communities. Renderings may not be drawn to scale. Any provided dimensions are approximate and actual dimensions may vary. Homes may be constructed with a floorplan that is the reverse of the floorplan rendering. Plans are copyrighted and/or otherwise subject to intellectual property rights of Meritage and/or others and cannot be reproduced or copied without Meritage's prior written consent. Plans and specifications, home features, and community information are subject to change, and homes to prior sale, at any time without notice or obligation. Additionally, deviations and variations may exist in any constructed home, including, without limitation: (i) substitution of materials and equipment of substantially equal or better quality; (ii) minor style, lot orientation, and color changes; (iii) minor variances in square footage and in room and space dimensions, and in window, door, utility outlet, and other improvement locations; (iv) changes as may be required by any state, federal, county, or local governmental authority in order to accommodate requested selections and/or options; and (v) value engineering and field changes.

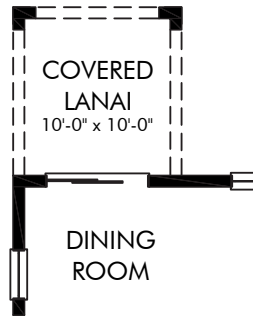

OPT. COVERED LANAI 1

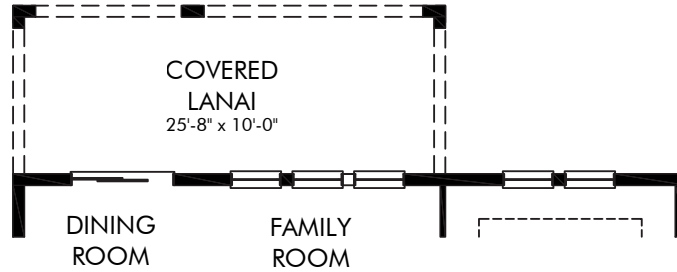

OPT. COVERED LANAI 2

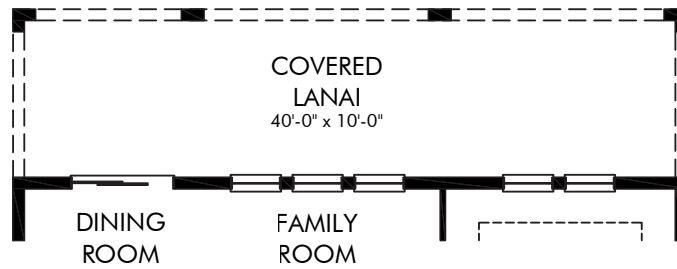

OPT. COVERED LANAI 3

Serenity Creek | Foxtail | Options

2,316 sq. ft. | 4 Bed | 2 Bath | 3 Car Garage | 1 Story

FLEX LIVING OPTIONS: Opt. Second Floor Game Room, Bedroom 5, Bath 4 & Opt. Wet Bar, Opt. Study or Game Room ILO Bedroom 4, Opt. Study ILO Flex, Opt. Master Bath, Opt. Bath 3 or Powder Bath ILO Second Master W.I.C., Opt. Tray Ceiling in Master Suite and Foyer, Opt. Covered Lanai 1, 2, or 3

Any floorplan and/or elevation rendering is an artist's conceptual rendering intended to provide a general overview, but any such rendering does not constitute actual plans and specifications for any home. Renderings and pictures are representative and may depict floorplans, elevations, options, upgrades, landscaping, and other features and amenities that are not included as part of all homes and/or may not be available for all lots and/or in all communities. Renderings may not be drawn to scale. Any provided dimensions are approximate and actual dimensions may vary. Homes may be constructed with a floorplan that is the reverse of the floorplan rendering. Plans are copyrighted and/or otherwise subject to intellectual property rights of Meritage and/or others and cannot be reproduced or copied without Meritage's prior written consent. Plans and specifications, home features, and community information are subject to change, and homes to prior sale, at any time without notice or obligation. Additionally, deviations and variations may exist in any constructed home, including, without limitation: (i) substitution of materials and equipment of substantially equal or better quality; (ii) minor style, lot orientation, and color changes; (iii) minor variances in square footage and in room and space dimensions, and in window, door, utility outlet, and other improvement locations; (iv) changes as may be required by any state, federal, county, or local governmental authority in order to accommodate requested selections and/or options; and (v) value engineering and field changes.